



**RIDGEFIELD ROUNABOUT COMMITTEE
MEETING AGENDA**

**Monday, September 8, 2025
RACC - Columbia Assembly Room
510 Pioneer Street, Ridgefield, WA 98642**

I. GENERAL SESSION CALL TO ORDER - 6:30 PM

- 1. Flag Salute**
- 2. Roll Call**
- 3. Late changes to the agenda**

II. CONSENT AGENDA

- 1. Approval of Minutes from the June 9, 2025 Meeting**

III. PUBLIC COMMENT

Anyone requesting to speak to the Committee regarding all items not subject to a specific Public Hearing may come forward at this time. Please state your name and limit comments to three minutes. Written comments may be submitted to the Clerk prior to the meeting.

IV. BUSINESS

- 1. Meet and Greet - Miranda Lange, PW Infrastructure Deputy Director**
- 2. S. Royal/S. Wells Roundabout Review - Miranda Lange, PW Infrastructure Deputy Director**

V. STAFF REPORTS

VI. FROM THE COMMITTEE

VII. ADJOURN

**CITY OF RIDGEFIELD
REQUEST FOR BOARD ACTION**

MEETING DATE: September 8, 2025

AGENDA ITEM NAME: Approval of Minutes from the June 9, 2025 Meeting

SUMMARY/BACKGROUND:

STAFF CONTACT: Diana Allen, Administrative Coordinator

ATTACHMENTS:

1. Roundabout Committee Minutes 6-9-2025



**CITY OF RIDGEFIELD, WASHINGTON
ROUNDBOUT COMMITTEE MEETING MINUTES
JUNE 9, 2025**

Regular Meeting - 6:30 PM

I. GENERAL SESSION CALL TO ORDER - 6:30 PM

- 1. Flag Salute**
- 2. Roll Call**

<p>Present: Committee Member Kelley McMorris Committee Member Heather Gordon Committee Member Kathleen Huber Committee Member Dan Mittelstadt</p> <p>Absent: Committee Member Tim Shell</p>

- 3. Late changes to the agenda**

None

II. CONSENT AGENDA

- 1. Approval of Minutes from the May 12, 2025 Meeting.**

<p>RESULT: (UNANIMOUS)</p> <p>MOVER: Committee Member Kelley McMorris</p> <p>SECONDER: Committee Member Kathleen Huber</p> <p>AYES: Chair Heather Gordon, Member Kelley McMorris, Committee Member Dan Mittelstadt, Committee Member Kathleen Huber</p>

III. PUBLIC COMMENT

Anyone requesting to speak to the Committee regarding all items not subject to a specific Public Hearing may come forward at this time. Please state your name and limit comments to three minutes. Written comments may be submitted to the Clerk prior to the meeting.

None

IV. BUSINESS

- 1. Continued discussion of S Royle Road at S Wells Drive/S 15th Street roundabout. - Chuck Green,**

Public Works Director

Principal of Nature Play Designs, Jane Tesner Kleiner presented the committee with three concepts for the S Royle Road at S Wells Drive/S 15th Street roundabout.

In July, Jane will meet with Committee Member Huber and Chair Gordon in an unofficial progress meeting prior to completing the first concept to be brought to the City Council for a temperature check at the July 24th City Council meeting.

V. STAFF REPORTS

Documents from Apex will be shared with the Committee to gain feedback on materials, planting plan and notes provided.

It was agreed that the July Roundabout Committee meeting would be canceled to accommodate a scheduled break.

VI. FROM THE COMMITTEE

The Committee thanked Engineering & Capital Director, Chuck Green, for all his hard work and wished him well on his retirement.

VII. ADJOURN

7:51PM

Diana Allen, Clerk

Chair

**CITY OF RIDGEFIELD
REQUEST FOR BOARD ACTION**

MEETING DATE: September 8, 2025

AGENDA ITEM NAME: Meet and Greet

SUMMARY/BACKGROUND:

STAFF CONTACT: Miranda Lange, PW Infrastructure Deputy Director

ATTACHMENTS:

None

**CITY OF RIDGEFIELD
REQUEST FOR BOARD ACTION**

MEETING DATE: September 8, 2025

AGENDA ITEM NAME: S. Royal/S. Wells Roundabout Review

SUMMARY/BACKGROUND:

STAFF CONTACT: Miranda Lange, PW Infrastructure Deputy Director

ATTACHMENTS:

1. Ridgefield Roundabout project DRAFT 6.6.25



S. ROYLE ROAD &
S. WELLS DRIVE / S. 15TH STREET
ROUNDBABOUT CONCEPTUAL DESIGN

Plans prepared for:
City of Ridgefield - Public Works
Ridgefield Roundabout Citizen Committee

DRAFT v. June 6, 2025

Source: Google Maps

PROJECT BACKGROUND

PROJECT GOALS

The City of Ridgefield, WA (City) has planned road improvements to support continued residential and commercial growth in the city limits. A part of the growth, the City is using roundabouts as a means of traffic control.

This project at the intersection of S. Royals Rd. and S. Wells Dr. is a medium sized roundabout serving primarily resident neighborhoods and through traffic to the high school and sports complex to the south and a mixed use commercial district to the north.

This round shall have a theme that is different than many of the existing roundabout in Ridgefield. While situated in historic agricultural areas and farms, it will celebrate the history of the area, both agriculturally and the native habitat environment that is common in Ridgefield.

PROJECT OBJECTIVES

As part of this project, input will include the City of Ridgefield Public Works (CORPW) director, CORPW Head of Transportation Maintenance and the City's residential advisory roundabout committee. Here are some of the key objectives identified by the participants to date, knowing more input will be forthcoming:

- **Low maintenance** - select plants that have an aesthetically pleasing mature shape that does not need pruning
- **Visual support** - use plant materials to block views of on-coming headlights to increase safe driving conditions
- **Use of native plants** - select plant materials that provide year round aesthetic appeal as well as supportive to the ecosystem health of the area. Use a mix of evergreen (keeps leaves all year) and deciduous (loses leaves)
- **Celebrate and enhance the neighborhood** - choose a plant layout and design that blends with the neighborhood and overall community

PROJECT EXAMPLES

The City of Ridgefield, WA (City) has used roundabouts as a traffic control media for many years. This project should not necessarily replicate the other existing roundabouts. These examples can be used by the City of Ridgefield Roundabout Committee (CRR) to identify features that people like and what has not been as successful to avoid in this design.

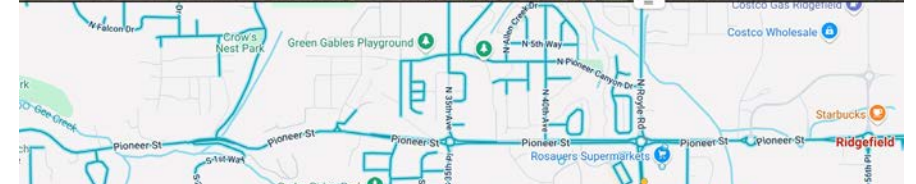
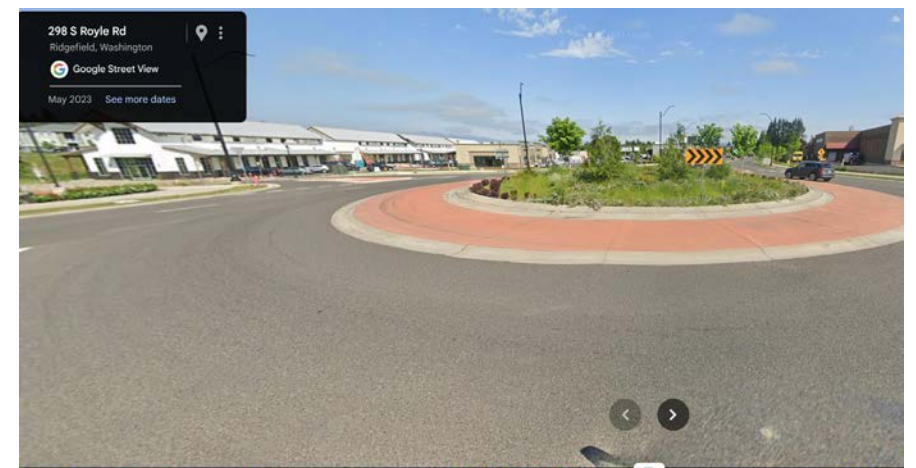
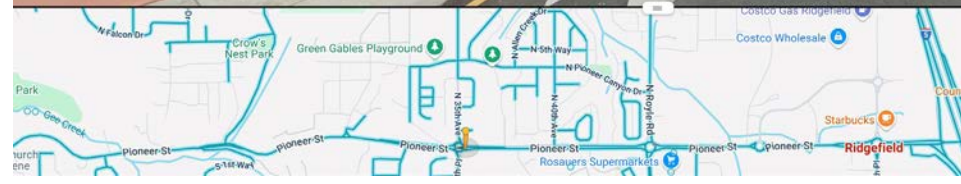

From the existing roundabouts, let us know what you think:

What features do you like?

What features are not a hit?

Tall trees? Lots of flowering shrubs?

Signage? No signage? Art? Blend in or stand out?

Manicured & trimmed? More natural like greenways?



PROJECT INPUT

KEY INPUT TO DATE:

FUNCTIONALITY

- Safety - The site has lots of existing utilities that will need maintenance access and safe use by maintenance staff
- The roundabout is to control direction and speed of cars. Landscape should help shield visual distractions (e.g. headlights, glare from traffic, sight distance clearances, etc.)
- A 2'-tall concrete knee wall will surround the landscape bed and include reflectors to keep cars from speeding through the interior area
- Low maintenance plantings that require minimum pruning (outside of hazard care) and will establish over time to reduce water needs. Plant densely to shade out weed growth. Pick drought tolerant and climate adapted species.
- Do NOT add anything (e.g. historic artifacts, art, plantings) that could attract visitors inside of the roundabout creating a pedestrian/vehicle safety concern....."not inviting to get close", appreciate from afar. Leave no space to walk into or gather inside the planted area.

AESTHETICS

- Ridgefield has a historic forested and agricultural aesthetic. Replicate a classic Pacific Northwest forested feel using native plants, reminds us of our PNW home
- Select plants that are beneficial to the local, regional and migratory wildlife, such as pollinator flowers, small berries for birds, etc. Don't use plants that create a lot of maintenance mess (i.e. large berries, large leaves, dropped branches, etc.)
- Select a plant palette to provide year round blooms. Plant in clusters to make weeding more easily identified plant vs. weed. Where possible, use plants from the "Portland Plant List" of beneficial native plants to our region (H. Gordon provided a list of potential plants)



VIEW OF INTERSECTION LOOKING NORTH

- Use layers of plantings with tall overstory trees (evergreens), shall colorful trees, medium & low shrubs, as well as dense ground cover along the edges. Pick plants that will not necessarily "spill over" the wall blocking reflectors
- Consider local / regional artists to add painting to the knee wall to celebrate region's history.

IMPORTANT FACTORS

- The existing utilities in the circle will need to be modified slightly to raise the rim elevations to finish grade levels. Coordinate with CORPW staff.
- Maintain access around utility access points as a safe zone for workers. Where access is needed, consider using a "walkable" groundcover that can withstand occasion walking
- The landscape island is very exposed and will be hot in the summer months.
- Irrigation water is available and irrigation layout will need to be considered for the site. Use water conservation techniques for irrigation and drought tolerant with the expectation that water could be turned off once plants are established.
- Use shredded bark mulch layer to help keep weeds down and water in the root zone
- There are good examples from other communities, such as the City of Lacey, that we could potential replicate.

What else do you want us to consider with the plant selection and layout, as well as other features?

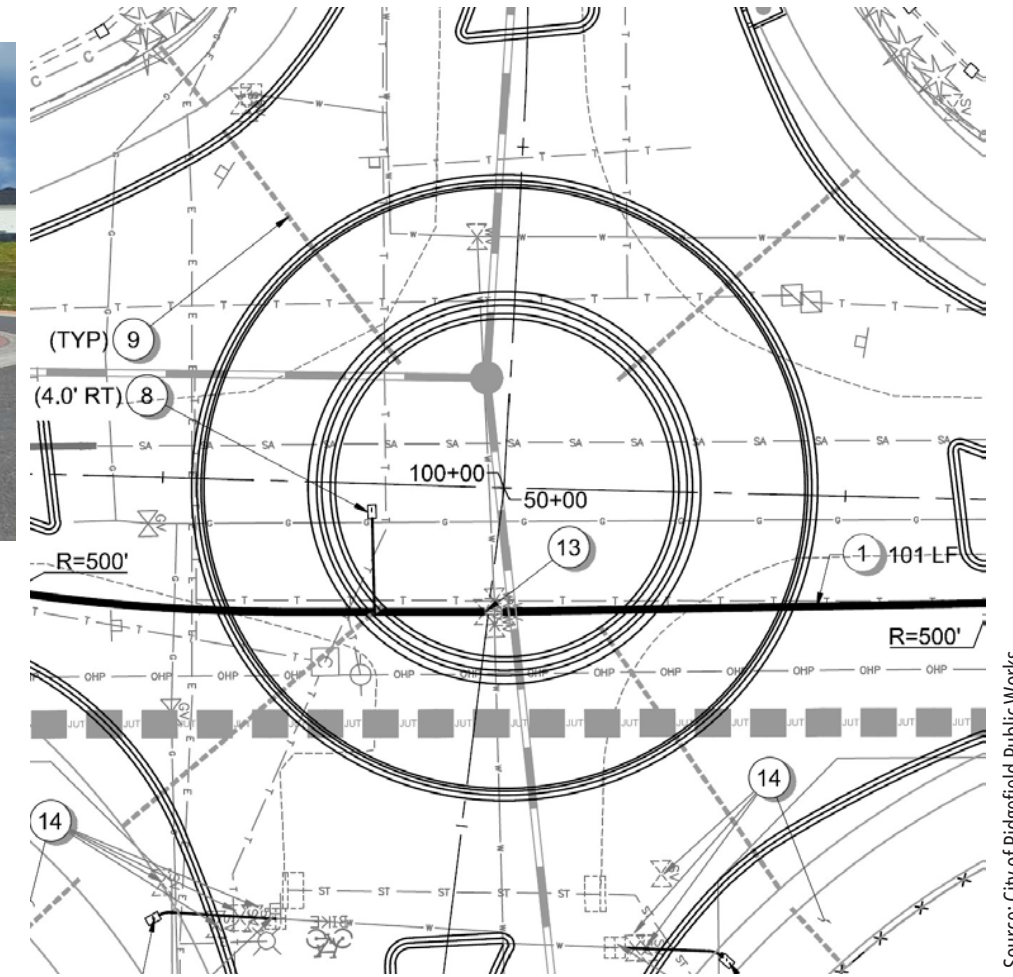

Source: City of Ridgefield Public Works

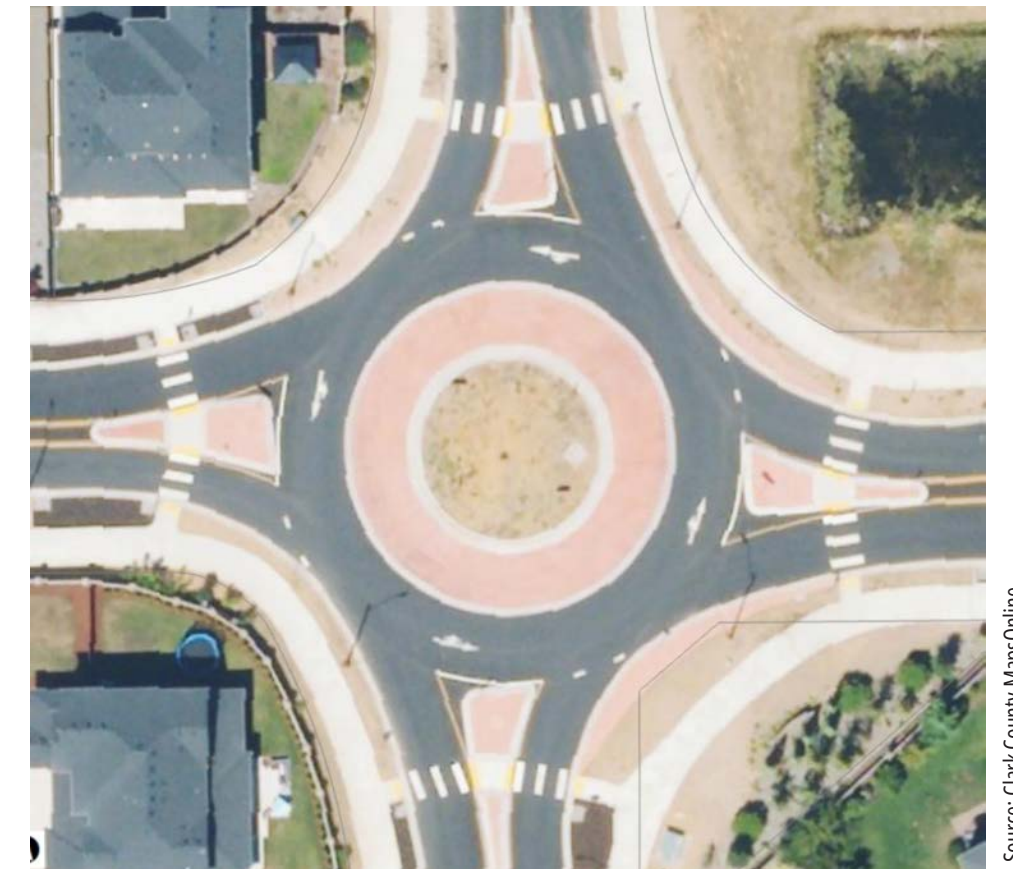

Source: Clark County MapsOnline

PROJECT CONCEPTS

CONCEPT A

Building on interests for native plants, Concept A recreates a Pacific Northwest forest with lots of evergreen trees, shrubs and perennial flowers. This concept represents layers of habitat:

- Overstory trees - Douglas firs or Pine
- Understory trees - Western crabapple or Serviceberry
- Medium shrubs - Mockorange, Red-twig dogwood
- Low shrubs - Evergreen huckleberry, Douglas spirea, Buckbrush
- Groundcover - Klunnikinnick, Camas, Stonecrop, etc.

Intermix evergreen with deciduous for diversity of habitat and colors. Use plants with interesting branching such as manzanita and dogwood. Densely plant at the on-set as it will take awhile for the plants to reach maturity.

DESIGN PRINCIPLES:

FOCUS ON ADDING NATIVE / POLLINATOR BENEFICIAL, ESPECIALLY FOR A WIDE VARIETY OF POLLINATORS



POLLINATOR FRIENDLY
EXTENDED BLOOM TIMES, DIVERSE FLOWER SHAPES/COLORS FOR HUMMINGBIRDS



GREAT CURB APPEAL
LOOKS GREAT YEAR ROUND, WITH DIVERSITY OF FLOWERS, COLORS, TEXTURES AND INTEREST

SAFETY & SECURITY
MAINTAIN SAFE ACCESS, CLEAR VIEWS AROUND THE SITE



LOW MAINTENANCE
MINIMAL TRIMMING REQUIRED, BLOCK WEED GROWTH & DROUGHT TOLERANT

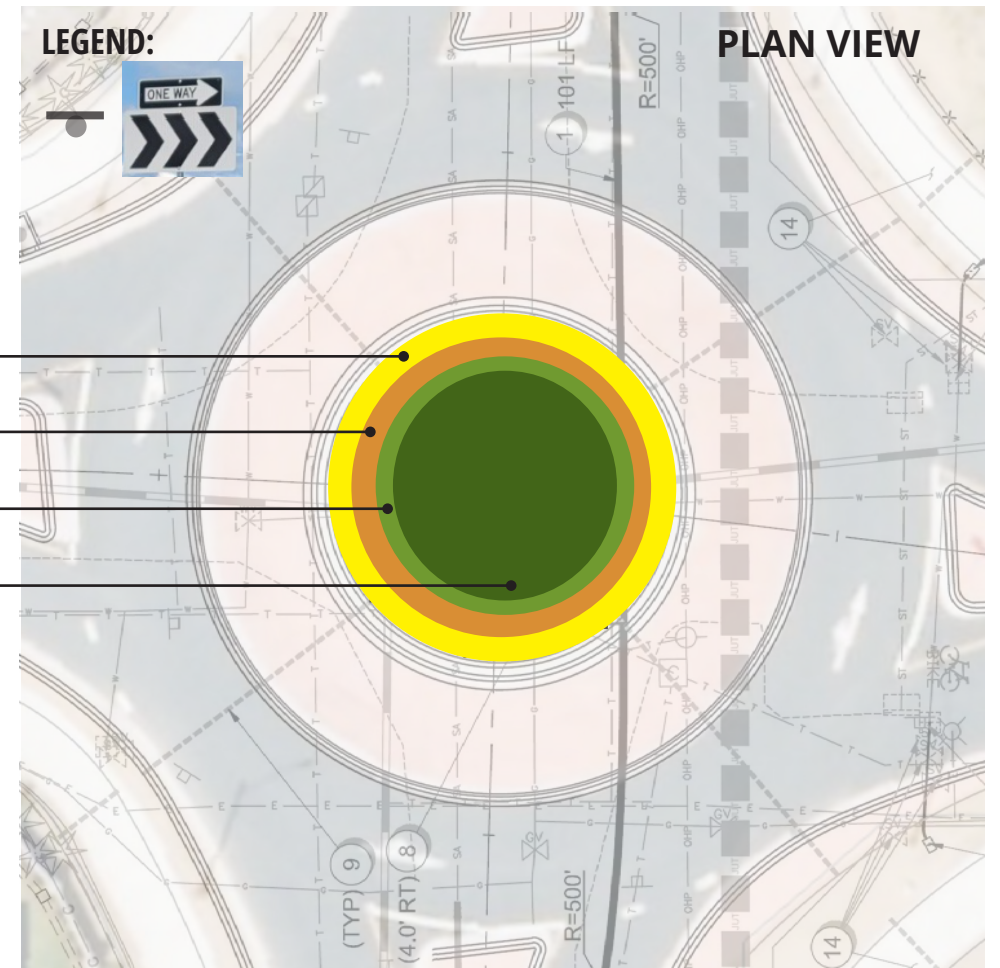

Low - less than 18"

Medium - 18" - 48"

Understory - 8' - 20'

Overstory - above 20'

Overstory trees

Understory trees

Medium shrubs

Low shrubs

Groundcover



CONCEPT B

Concept B has medium height by using medium height deciduous trees that have excellent spring and fall colors as the highlights. Large shrubs create a dense cluster of different flowering plants with accenting color combinations. The whole perimeter is a blend of low evergreen plantings such as sedum and buckbrush, with occasional perennials adding accent colors, such as camas, yarrow, and pearly everlasting. This concepts represents layers of habitat:

- Overstory trees - Oak or Maple
- Large shrubs - Red-flowering currant, Tall Oregon Grape
- Low shrubs - Evergreen huckleberry, Douglas spirea, Buckbrush
- Groundcover - Klunikinnick, Camas, Stonecrop, etc.

Intermix evergreen with deciduous for diversity of habitat and colors. Use plants with interesting branching such as manzanita and dogwood. Densely plant at the on-set as it will take awhile for the plants to reach maturity.

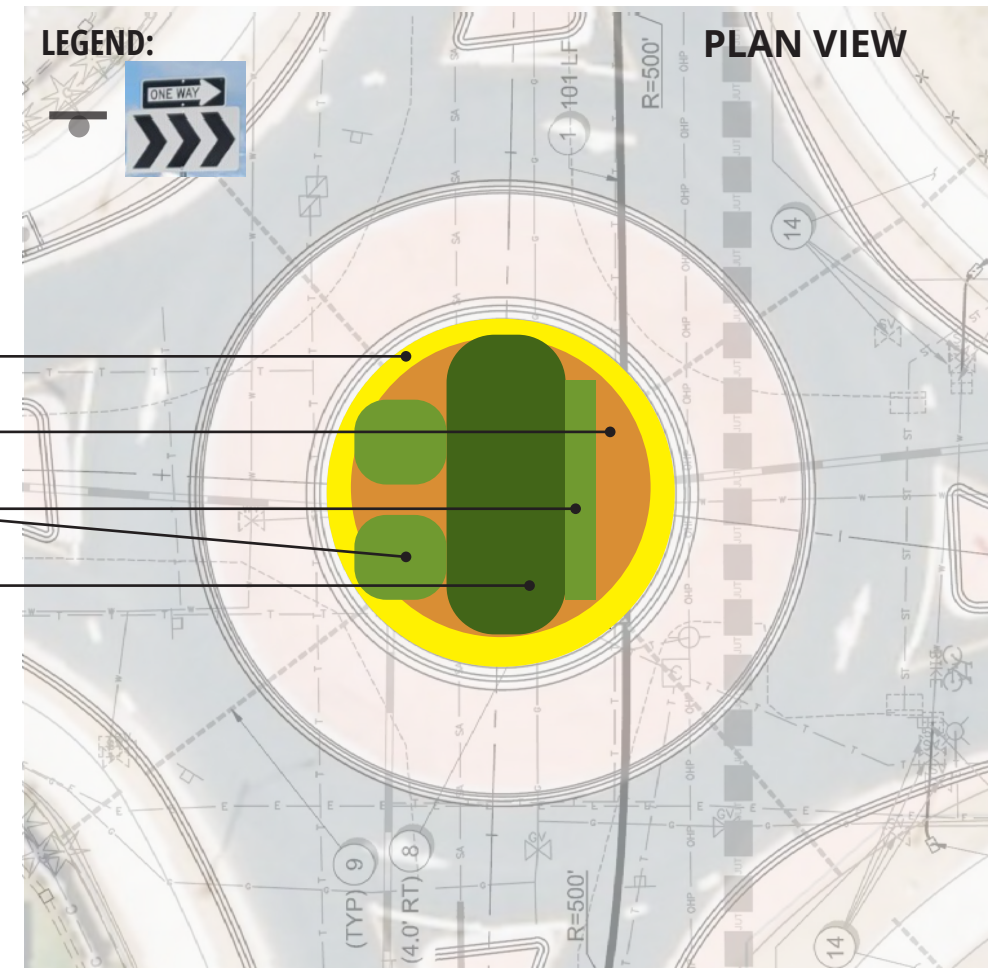

CONCEPT C

Concept C has a lower height by using medium height shrubs such as wild lilac, manzanita and Pacific wax myrtle. The whole perimeter is a blend of low evergreen plantings such as sedum and buckbrush, with occasional perennials adding accent colors, such as camas, yarrow, and pearly everlasting. This concepts represents layers of habitat:

- Overstory trees - Oak or Maple
- Large shrubs - Evergreen shrubs including wild lilac and manzanita
- Low shrubs - Evergreen huckleberry, Douglas spirea, Buckbrush
- Groundcover - Klunikinnick, Camas, Stonecrop, etc. Consider using rhizome perennials / easily seeded to fill in the space such as douglas aster, pearly everlasing, Oregon sunshine, etc.

Intermix evergreen with deciduous for diversity of habitat and colors. Use plants with interesting branching such as manzanita and dogwood. Densely plant at the on-set as it will take awhile for the plants to reach maturity.

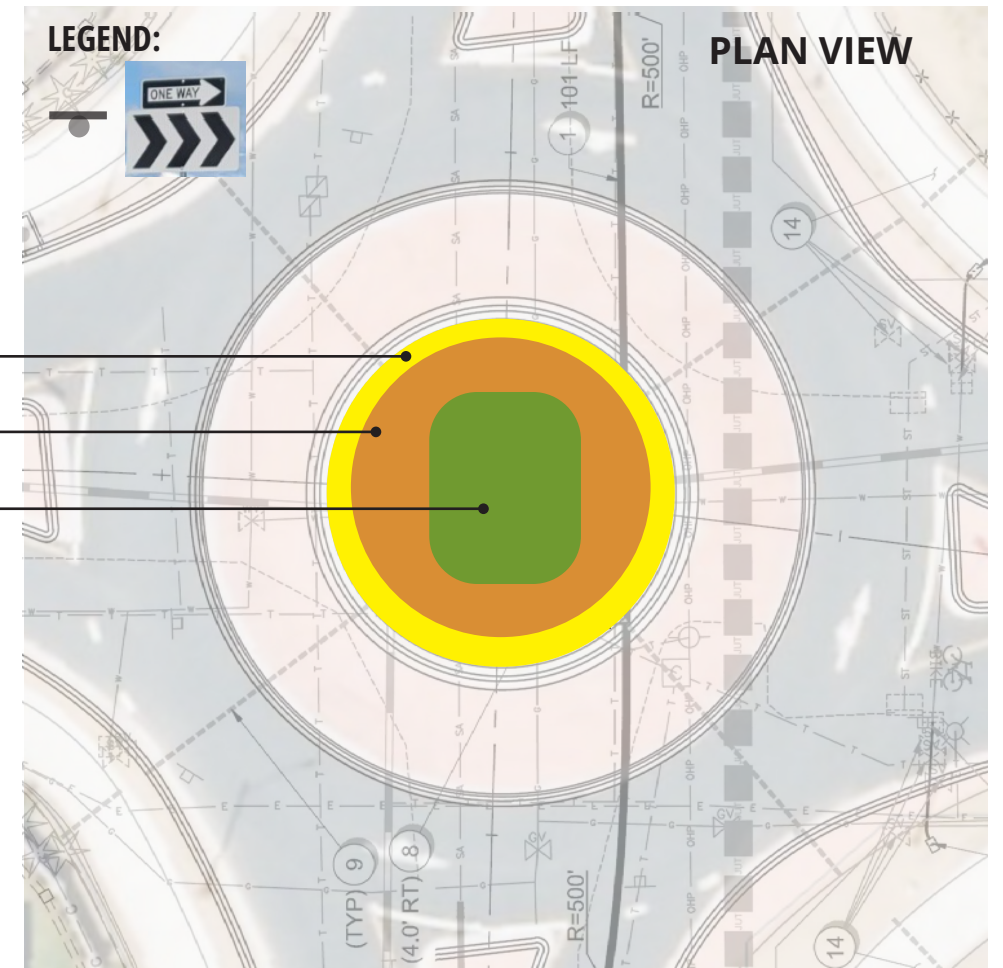

Groundcover - less than 18"

Low shrubs - 18" - 48"

Large shrubs - 4' - 8'



Large shrubs

Low shrubs

Groundcover

POTENTIAL PLANT LIST

NOTE:

There are lots of choices for plants, that have been shown to support local pollinators and are readily available from local nurseries. References used include the Portland Plant List, OSU Extension Pollinator research, Washington Native Plant Society, Vancouver Bee Project, etc.

TREES

TALL TREE

DOUGLAS FIR **PNW** SHORE PINE **PNW**

MEDIUM TREE

CASCARA **PNW**

WESTERN CRABAPPLE **PNW** WESTERN SERVICEBERRY **PNW**

SMALL TREE

VINE MAPLE **PNW**

SHRUBS

TALL SHRUB

INDIAN PLUM **PNW** WILD LILAC **PNW**

MOCK ORANGE **PNW** TALL OREGON GRAPE **PNW**

MEDIUM SHRUB

BIRCH LEAVED SPIREA **PNW** OREGON TEA **PNW** BUCK BUSH **PNW**

EVERGREEN HUCKLEBERRY **PNW** SALAL **PNW**

SMALL SHRUB

LOW OREGON GRAPE **PNW** VINE - NATIVE HONEYSUCKLE **PNW**

GROUND COVER / PERENNIALS

MEDIUM PROFILE

PNW DOUGLAS ASTER **PNW** LUPINE

PNW PACIFIC BLEEDING HEART **PNW** LUPINE

PNW BLANKET FLOWER **PNW** SCARLET MONKEY FLOWER

PNW YARROW **PNW** PEARLY EVERLASTING

PNW OREGON SUNSHINE **PNW** KINNICKINICK

PNW WILD/COASTAL STRAWBERRY **PNW** BLUE-EYED GRASS

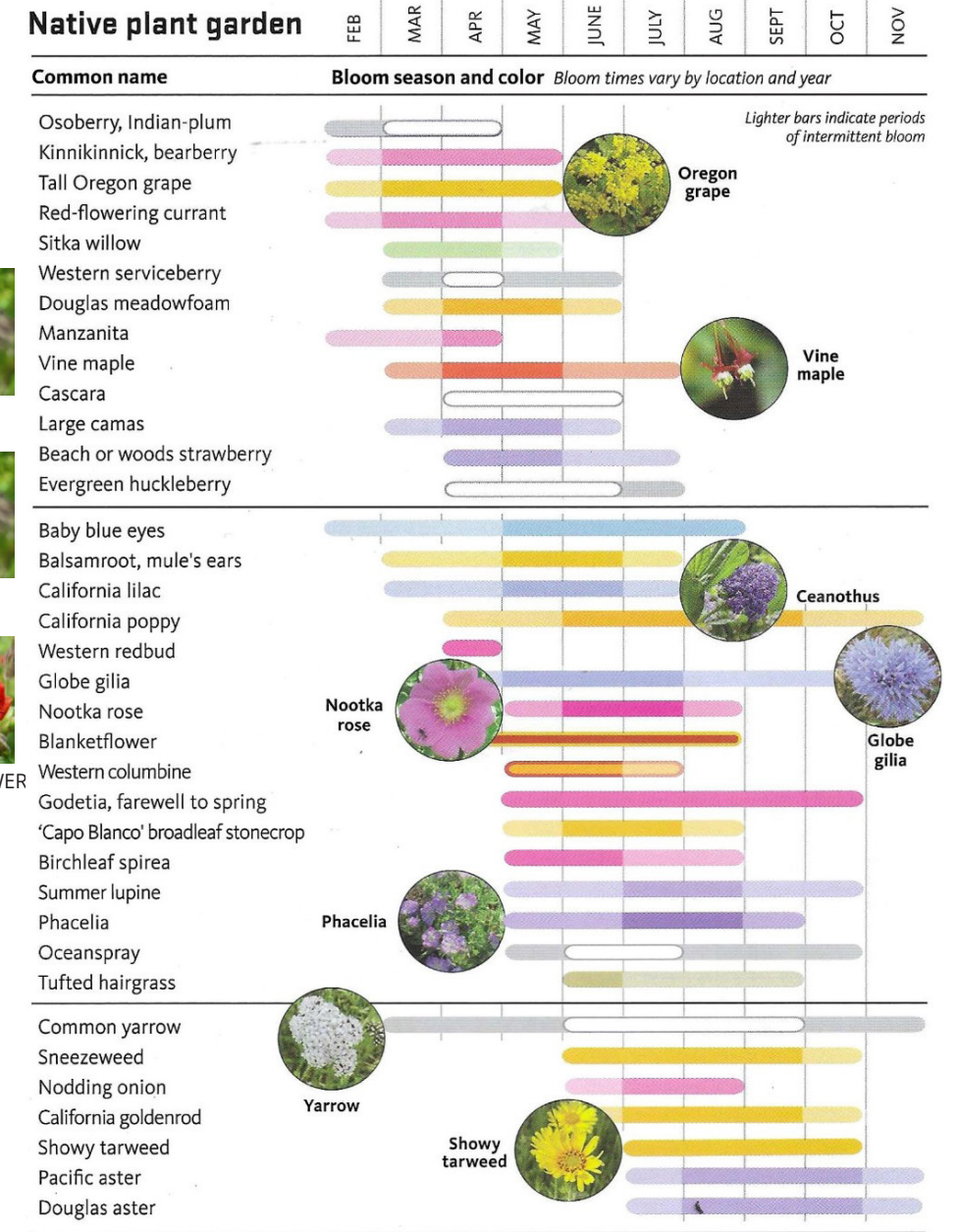

© 2020 Oregon State University. Oregon State University Extension Service prohibits discrimination in all its programs, services, activities, and materials on the basis of race, color, national origin, religion, sex, gender identity (including gender expression), sexual orientation, disability, age, marital status, familial/parental status, income derived from a public assistance program, political beliefs, genetic information, veteran's status, reprisal or retaliation for prior civil rights activity. (Not all prohibited bases apply to all programs.)